

**GOVERNMENT OF ANDHRA PRADESH**

**AMARAVATI DEVELOPMENT CORPORATION**

**Notice Inviting Tenders [Sealed quotations]**

Department.	:	Amaravati Development Corporation Limited.
Unit / Circle / Division	:	ADCL, Vijayawada
NIT No.	:	Quotation Box Tender Notice No. 17/CE/ADC/Engg/2018-19
File No.	:	124/CE/ADC/VJA/Engg/2018
Name of the work	:	Supply & fixing Decorative & Ornamental works with FRP sheet for Columns, beams, trellis, windows, Stair cases including MS Works and also Supply & Fixing of different types of Water features(fountains) with all necessary Spouts, LED lights & Pumps, electrical panels for the Fountains including 5 years O&M at Amaravati Central Park, Amaravati Capital City, Andhra Pradesh
Form of Contract	:	<b>Item rate</b>
Tender Type	:	<b>Sealed Quotations(open)-Conventional Method</b>
Eligible Class of Contractor's.	:	Reputed firms/ Manufacturers/ Suppliers
Category.	:	<b>General</b>
Schedule opening date	:	<b>20-07-2018 from 3.00 PM</b>
Schedule closing date	:	<b>28-07-2018 up to 2.00 PM</b>
Bid submission closing date	:	<b>28-07-2018 up to 3.00 PM</b>
Bid Opening date.	:	<b>28-07-2018 @4.00 PM</b>

**QUALIFICATION CRITERIA.**

**1) Registration.**

Sd/-  
Chief Engineer  
ADCL, VIJAYAWADA

Class of Contractor Eligible	:	Reputed firms / Manufacturers/ Suppliers
Category	:	. Open .

### **SUBMISSION OF BIDS**

The bidders who are desirous of to quote the rates shall submit their Tender, in the Standard Formats prescribed in the Tender documents placed at web site [Web: www.ccdmc.co.in](http://www.ccdmc.co.in). The quote to be submitted as per the appended format.

The bidder shall sign on the quotation submitted by him accepting responsibility for their correctness / authenticity.

The attested copies of certificates; documents as listed in the Statement in support of Technical bid are to be submitted by the bidder to the CMD, ADCL. The bidder shall not submit any certificate / documents other than those listed. Similarly, if any of the certificates, documents etc., furnished by the bidder is found to be false / fabricated / bogus the bidder will be suspended from participating in the quote.

The following qualification information to fulfill the above eligibility criteria shall be furnished at the time of quote submission.

- a) Copy of firm/Manufacturer/ Dealer ship Registration Certificate.
- b) Contact number with Email ID and Address.
- c) The bidder shall sign on the all statements, documents, certificates submitted by him along with the quote.

**d) All Communications about this bid must be made:**

To

The Chairperson and Managing Director,

Amaravati Development Corporation,

Anand heights, Near Prabhas College,

Kedareswarapet, Vijayawada,

Krishna District- 520003. Andhra Pradesh (India)

Sd/-  
Chief Engineer  
ADCL, VIJAYAWADA

## SCOPE OF WORK

The information and data furnished herein relevant to the work and site conditions are general. It shall be the responsibility of the contractor to fully acquaint himself with the nature and location of works, quarries, local conditions and other aspects, which are relevant to the work.

**Location of the work:** Supply & fixing Decorative & Ornamental works with FRP sheet for Columns, beams, trellis, windows, Stair cases including MS Works and also Supply & Fixing of different types of Water features(fountains) with all necessary Spouts, LED lights & Pumps, electrical panels for the Fountains including 5 years O&M at Amaravati Central Park, Amaravati Capital City, Andhra Pradesh.

**Details of works:** The detailed specifications are as follows:

### I. FRP Sheet:

- a. Supply & Fixing of FRP (Fibre Reinforced Plastic) not less than 3mm thick for ornamental elements like Fountains, Columns, Beams, Trellis, Windows and Staircase Railing with necessary frame work with Mild steel.
- b. Supply & Fixing of FRP (Fibre Reinforced Plastic) not less than 3mm thick for decorative and ornamental elements like 6'6" height Lamp Posts.

### II. Western Style Candle water feature:

Supply & Fixing of water feature consisting of 9 towers at a spacing of 4.00m with a height of 6.20mt with Dolphin like structure at bottom and the water spouts come out from the dolphin's mouth considering 16mm dia. spout from top of the tower and 12mm dia. spout from dolphin mouth with 2 no.s, 3hp Pump and 18 no.s 21W LED light (RGB) and out door electrical panel.

### III. Indian style candle water feature

Supply & Fixing of Indian style candle water feature consisting of 9 towers at a spacing of 4.00m with a height of 6.00mt with Dolphin & Horse like structure at bottom and the water spouts come out from the Horse's & dolphin's mouth considering 16mm dia. spout from horse's mouth and 12mm dia. spout from dolphin mouth with 2 no.s, 3hp Pump and 18 no.s 21W LED light (RGB) and out door electrical panel.

### IV. Water features (Fountains)

- a. Supply and fixing of Water features (fountains) of sizes 14.10m x 2.10 m with 8.no.s foam jets with a maximum height of jets 1.50m, Pump 2 no.s of 5 HP, 16 no.s of 12 V, 21 W LED light (RGB) and electrical panel in out door enclosure.
- b. Small water body of dia. 2.00m at different locations in Central park with thick foam jets of 1.50m height and lit by white lights 12 no.s of 12 V, 18 W LED(RGB), 1.50 HP pump and out door electrical panel.
- c. Small Pool of size 14.70m x 4.80m as marked in master plan, 4 no.s Calyx aerating jet (50mm), Pump 3 HP 2 no.s, Lights 12 no.s of 12 V, 21 W LED lights (RGB) & Electrical panel in out door enclosure

Sd/-  
Chief Engineer  
ADCL, VIJAYAWADA

- Note:
1. The information furnished is the best available. However, the department does not guarantee the correctness of interpretations, deductions of conclusions, which are given as supplementary information. The information have been produced as found communicated ascertained or other wise learned by the department.
  2. INTENDING BIDDERS CAN CONTACT SUPERINTENDING ENGINEER (DESIGNS) , O/o CMD AMARVATHI DEVELOPMENT CORPORATION LIMITED, VIJAYAWADA FOR ANY CLARIFICATION INFORMATION ON ANY WORKING DAY DURING WORKING HOURS (PHONE NO. 7095599904)

Sd/-  
Chief Engineer  
ADCL, VIJAYAWADA

## Quotation

**Name of the Work:** Supply & fixing Decorative & Ornamental works with FRP sheet for Columns, beams, trellis, windows, Stair cases including MS Works and also Supply & Fixing of different types of Water features(fountains) with all necessary Spouts, LED lights & Pumps, electrical panels for the Fountains including 5 year O&M at Amaravati Central Park, Amaravati Capital City, Andhra Pradesh.

S.No.	Description/ Specification	Unit	Rate in INR	Amount in Words
<b>I</b>	<b>FRP Sheet:</b>			
	<b>a.</b> Supply & Fixing of FRP (Fibre Reinforced Plastic) not less than 3mm thick for ornamental elements like Fountains, Columns, Beams, Trellis, Windows and Staircase Railing with necessary frame work with Mild steel and all other necessary fittings & fixtures etc. complete including all incidental charges, labour, conveyance etc.	<b>Sq.m</b>		
	<b>b.</b> Supply & Fixing FRP (Fibre Reinforced Plastic) not less than 3mm thick for decorative and ornamental elements like 6'6" height Lamp Posts and all other necessary fittings & fixtures etc. complete including all incidental charges, labour, conveyance etc..	<b>Sq.m</b>		
<b>II</b>	<b>Western Style Candle water feature:</b>			
	Supply & Fixing of water feature consisting of 9 towers at a spacing of 4.00m with a height of 6.20mt with Dolphin like structure at bottom and the water spouts come out from the dolphin's mouth considering 16mm dia. spout from top of the tower and 12mm dia. spout from dolphin mouth with 2 no.s, 3hp Pump and 18 no.s 21W LED light (RGB) and out door electrical panel and all other necessary fittings & fixtures etc. complete including all incidental charges, labour, conveyance etc.	<b>1 Job</b>		

Sd/-  
Chief Engineer  
ADCL, VIJAYAWADA

<b>III</b>	<b>Indian style candle water feature:</b>			
	Supply & Fixing of Indian style candle water feature consisting of 9 towers at a spacing of 4.00m with a height of 6.00mt with Dolphin & Horse like structure at bottom and the water spouts come out from the Horse's & dolphin's mouth considering 16mm dia. spout from horse's mouth and 12mm dia. spout from dolphin mouth with 2 no.s, 3hp Pump and 18 no.s 21W LED light (RGB) and out door electrical panel and all other necessary fittings & fixtures etc. complete including all incidental charges, labour, conveyance etc.	<b>1 Job</b>		
<b>IV</b>	<b>Water features (Fountains)</b>			
	a. Supply and fixing of Water features (fountains) of sizes 14.10m x 2.10 m with 8.no.s foam jets with a maximum height of jets 1.50m, Pump 2 no.s of 5 HP, 16 no.s of 12 V, 21 W LED light (RGB) and electrical panel in out door enclosure and all other necessary fittings & fixtures etc. complete including all incidental charges, labour, conveyance etc.	<b>1 Job</b>		
	b. Small water body of dia. 2.00m at different locations in Central park with thick foam jets of 1.50m height and lit by white lights 12 no.s of 12 V, 18 W LED(RGB), 1.50 HP pump and out door electrical panel and all other necessary fittings & fixtures etc. complete including all incidental charges, labour, conveyance etc.	<b>1 Job</b>		
	c. Small Pool of size 14.70m x 4.80m as marked in master plan, 4 no.s Calyx aerating jet (50mm), Pump 3 HP 2 no.s, Lights 12 no.s of 12 V, 21 W LED lights (RGB) & Electrical panel in out door enclosure and all other necessary fittings & fixtures etc. complete including all incidental charges, labour, conveyance	<b>1 Job</b>		

Sd/-  
Chief Engineer  
ADCL, VIJAYAWADA

	etc.			
<b>V</b>	Comprehensive Operation & Maintenance (excluding Consumables) of all fountains and water features for five years from the date of Installation & Commissioning	<b>Per year</b>		

**Note:** Breakup for maintenance cost to be submitted

Signature, Name of the Manufacturer/Supplier/Authorized Signatory

Sd/-  
Chief Engineer  
ADCL, VIJAYAWADA

These drawings and the designs shown here are the property of Nitish Roy Design & Media. They shall not be copied, stored, transmitted or used without prior permission.

**Structural Consultants**  
Goru Consultancy  
Uppal  
Hyderabad  
Phone: 8686283540  
e-mail: goruconsultancy@live.in

**Electrical Consultant**  
Consultant: Sanjay Malik  
Address: Kolkata  
Phone: 07278472833  
e-mail: smcongru@gmail.com

**Plumbing and Sanitation Consultant**  
Consultant: Sikha Halder  
Address: Kolkata  
Phone: 09748175312  
e-mail: halder.sikha@gmail.com

No.	Description	Date
1	SCHEMATIC PLANS	
2	SCHEMATIC PLANS	
3	PLAN SET	26 SEP 17
4	PLAN SET	03 OCT 17
5	PLAN SET	13 NOV 17
6	TENDER DRAWINGS	20 NOV 17

**ADC ROSE &  
SCULPTURE  
GARDEN**

**WESTERN STYLE  
CANDLE FOUNTAIN**

Designed by	NR
Date	20 NOV 17
Drawn by	PY
Checked by	PK
<b>A114</b>	
Scale	As indicated

20/11/2017 9:15:18 AM

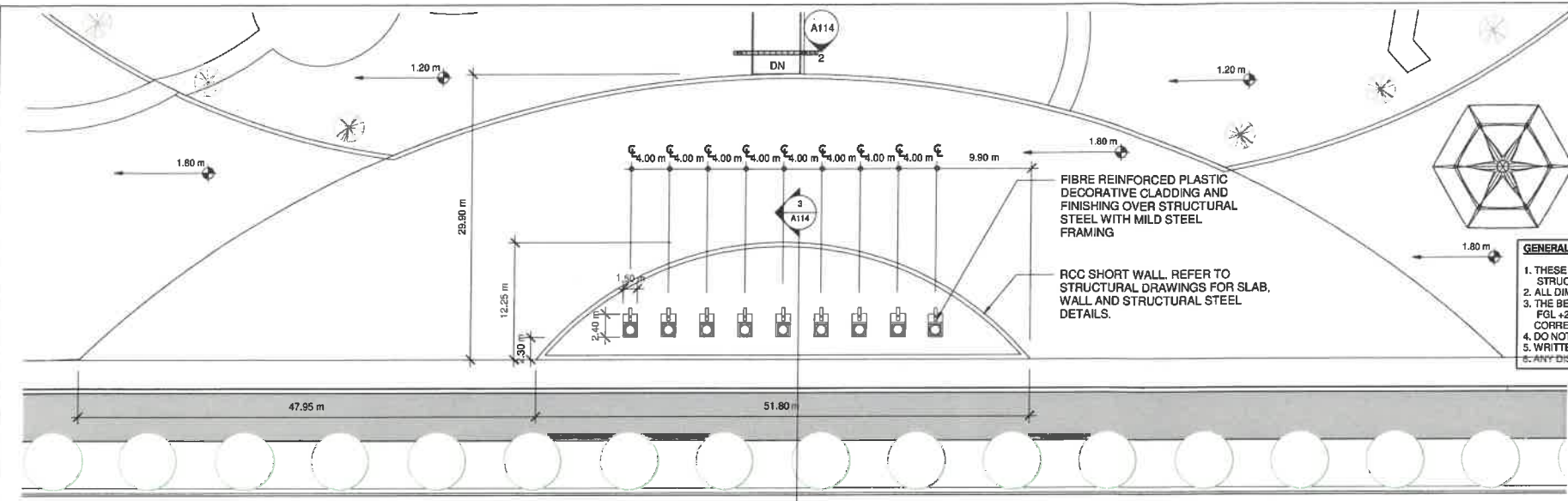

**GENERAL NOTES:**  
1. THESE DRAWINGS ARE TO BE READ IN CONJUNCTION WITH THE RELATED ARCHITECTURAL & STRUCTURAL DRAWINGS.  
2. ALL DIMENSIONS ARE IN METERS.  
3. THE BENCH MARK AT THE ENTRY LEVEL IS TAKEN AS 0.00 METRS., THIS CORRESPONDS TO THE FGL +24.0 M LVL. AS PER THE MASTER GRADING PLAN. ALL OTHER LEVELS SHALL CORRESPOND TO THIS.  
4. DO NOT SCALE THE DRAWINGS.  
5. WRITTEN DIMENSIONS TAKE PRECEDENCE OVER MEASURED DIMENSIONS.  
6. ANY DISCREPANCY SHALL BE BROUGHT TO THE NOTICE OF THE CONSULTANTS IMMEDIATELY.

**1 WESTERN STYLE CANDLE FOUNTAIN**  
1 : 300

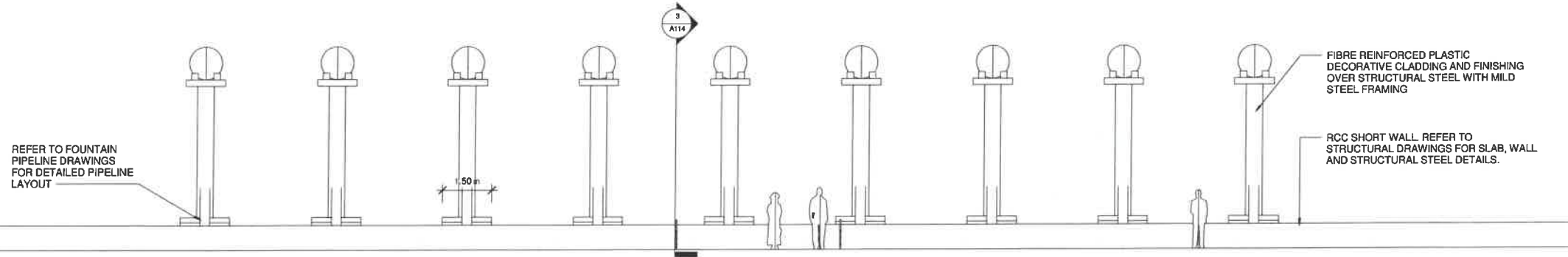

**2 WESTERN STYLE CANDLE FOUNTAIN - ELEVATION**  
1 : 75

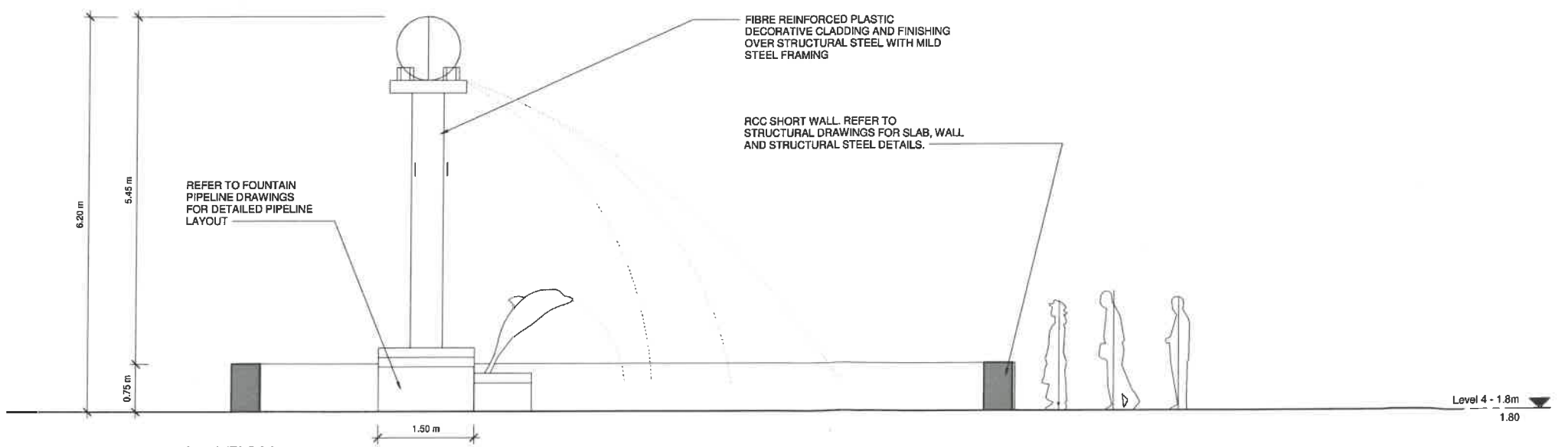

**3 WESTERN STYLE FOUNTAIN - SECTION**  
1 : 40



These drawings and the designs shown here are the property of Nitish Roy Design & Media. They shall not be copied, stored, transmitted or used without prior permission.

**Structural Consultants**  
Goru Consultancy  
Uppal  
Hyderabad  
Phone: 8886283540  
e-mail: goruconsultancy@live.in

**Electrical Consultant**  
Consultant: Sanjay Mallik  
Address: Kolkata  
Phone: 07278472833  
e-mail: smooingru@gmail.com

**Plumbing and Sanitation Consultant**  
Consultant: Sikha Halder  
Address: Kolkata  
Phone: 09748175312  
e-mail: halder.sikha@gmail.com

No.	Description	Date
1	SCHEMATIC PLANS	
2	SCHEMATIC PLANS	
3	PLAN SET	26 SEP 17
4	PLAN SET	03 OCT 17
5	PLAN SET	13 NOV 17
6	TENDER DRAWINGS	20 NOV 17

**ADC ROSE &  
SCULPTURE  
GARDEN**

**INDIAN STYLE FOUNTAIN**

Designed by **NR**

Date **20 NOV 17**

Drawn by **PY**

Checked by **PK**

**A108**

Scale **As indicated**

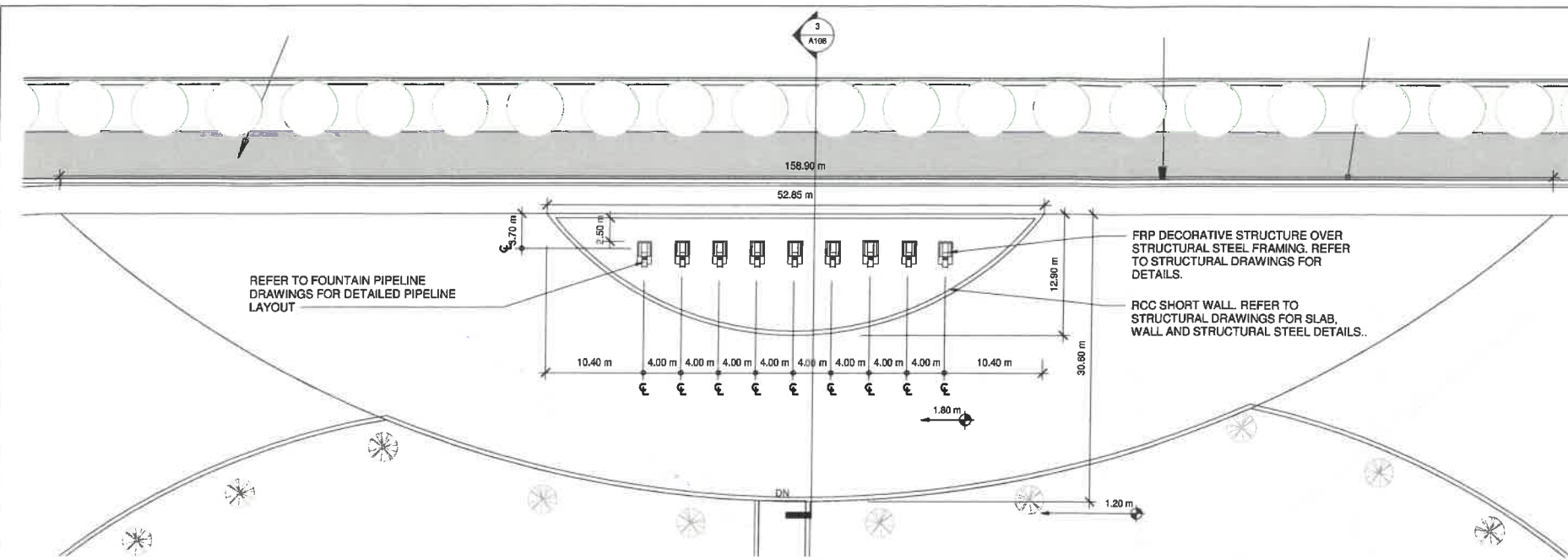

**1 INDIAN STYLE FOUNTAIN - PLAN**  
1 : 300

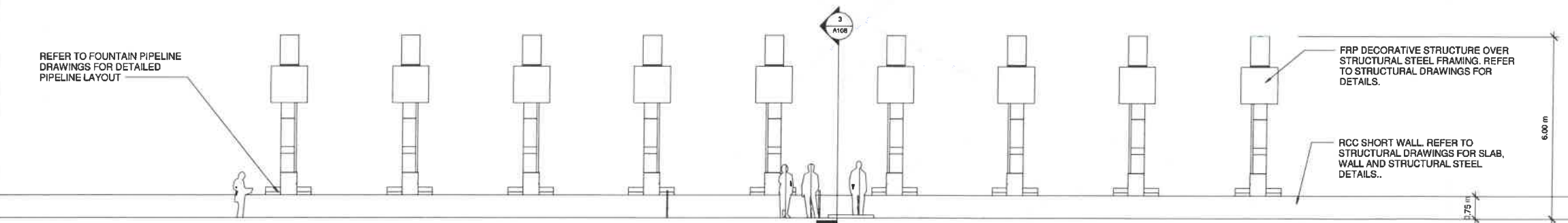

**2 INDIAN STYLE FOUNTAIN - ELEVATION**  
1 : 75

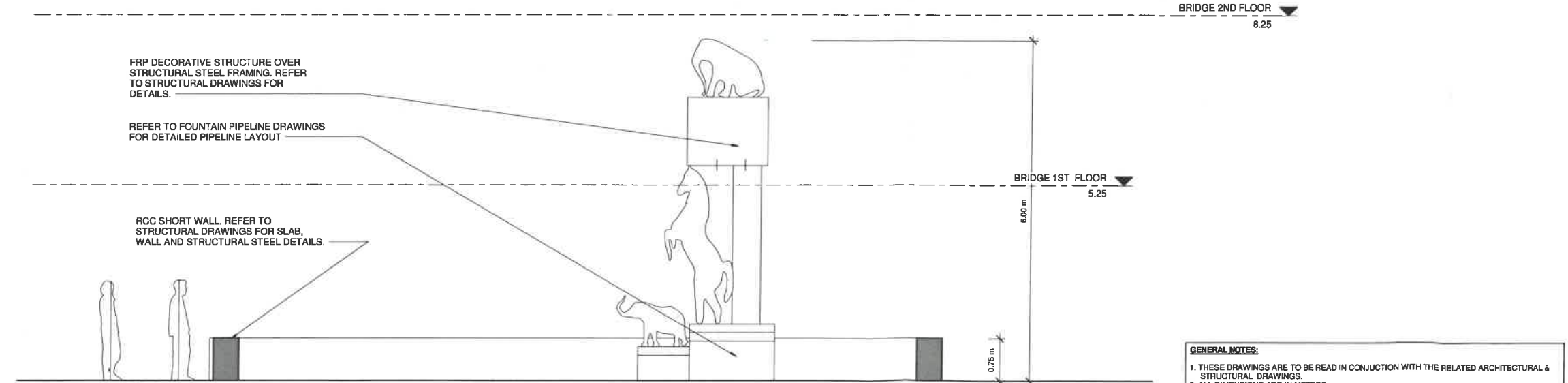

**3 INDIAN FOUNTAIN - SECTION**  
1 : 40

**GENERAL NOTES:**  
1. THESE DRAWINGS ARE TO BE READ IN CONJUNCTION WITH THE RELATED ARCHITECTURAL & STRUCTURAL DRAWINGS.  
2. ALL DIMENSIONS ARE IN METERS.  
3. THE BENCH MARK AT THE ENTRY LEVEL IS TAKEN AS 0.00 METRS., THIS CORRESPONDS TO THE FGL +24.0 M LVL, AS PER THE MASTER GRADING PLAN. ALL OTHER LEVELS SHALL CORRESPOND TO THIS.  
4. DO NOT SCALE THE DRAWINGS.  
5. WRITTEN DIMENSIONS TAKE PRECEDENCE OVER MEASURED DIMENSIONS.  
6. ANY DISCREPANCY SHALL BE BROUGHT TO THE NOTICE OF THE CONSULTANTS IMMEDIATELY.